

**WATER
LEAK
DETECTION**

30+
YEARS OF
EXPERIENCE

**PROTECT
LIFE &
PROPERTY**

COMMERCIAL
& RESIDENTIAL
BUILDINGS

ONE CONTROLLER FITS ALL

- ✓ BMS Communications
- ✓ Strobe Alarm Outputs
- ✓ Control Panel Connectivity
- ✓ Fault Detection
- ✓ Electronic Valve Control
- ✓ 230V or 24V Power Input

DESCRIPTION

The Merlin WLM system is the new S&S Northern Ltd permanent water leak detection system aimed towards commercial properties and residential apartment blocks. The Merlin WLM can be used standalone or part of a larger multi-zone detection system and comes with a clear LED status display.



MODERN

DESIGNS

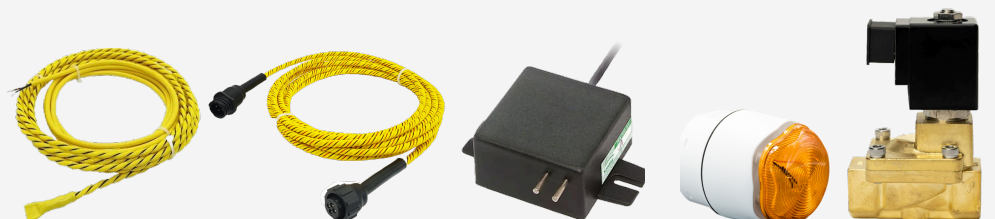

PROVIDING SAFETY & CONTROLS IN

- SCIENCE LABORATORIES
- BOILER ROOMS
- GAS & WATER FEATURES
- COMMERCIAL KITCHENS
- CAR PARKS
- OCCUPIABLE SPACES

FIND OUT MORE

info@snsnorthern.com
01257 470983

Select Your Sensor Attachments

WLMCP Pucks



The WLMCP is designed to identify water leaks, either at specific points or in larger areas. The puck/probe can be rotated on the mounting bracket and secured in place with a wing nut.

The WLMCP puck/probe should be utilized with the WLM and should not be directly linked to a BMS controller. The cable excitation employed is an isolated AC signal, ensuring that the detector cable remains unaffected by oxidation or erosion over time. This helps prevent the degradation issues associated with DC systems.

WLMC 2-Core Sensing Cable Pre-Defined Lengths - Pluggable



WLMC 2-Core leak detection ropes include a 2M lead wire, however this wire may be extended using alarm cable. The total length of lead wire and sensing cable may not exceed 60M. If more than 60M is required, use multiple WLM controllers.

Pre-defined 2-Core do not include fault detection.

The 2-Core sensing cable is an inexpensive option if only a single desired length is required for the project.

Available lengths: 2M, 5M, 10M, 15M & 25M.

WLMFC 4-Core Sensing Cable Pluggable With Fault Detection



WLMFC 4-Core ropes include fault detection, with many adaptable set ups to fit custom applications.

4-Core ropes are terminated with plugs that allow you to link multiple sensing cables together. This can be used for branching the rope into tees or adding lead wire in between sensing cables. The pluggable ropes come with less options for length due to the ability to link multiple smaller cables together to create a larger rope.

4-Core leak detection ropes do not include a lead wire. The total length of lead wire and sensing cable may not exceed 60M.

Available lengths: 5M, 10M, 20M, 50M, 100M.

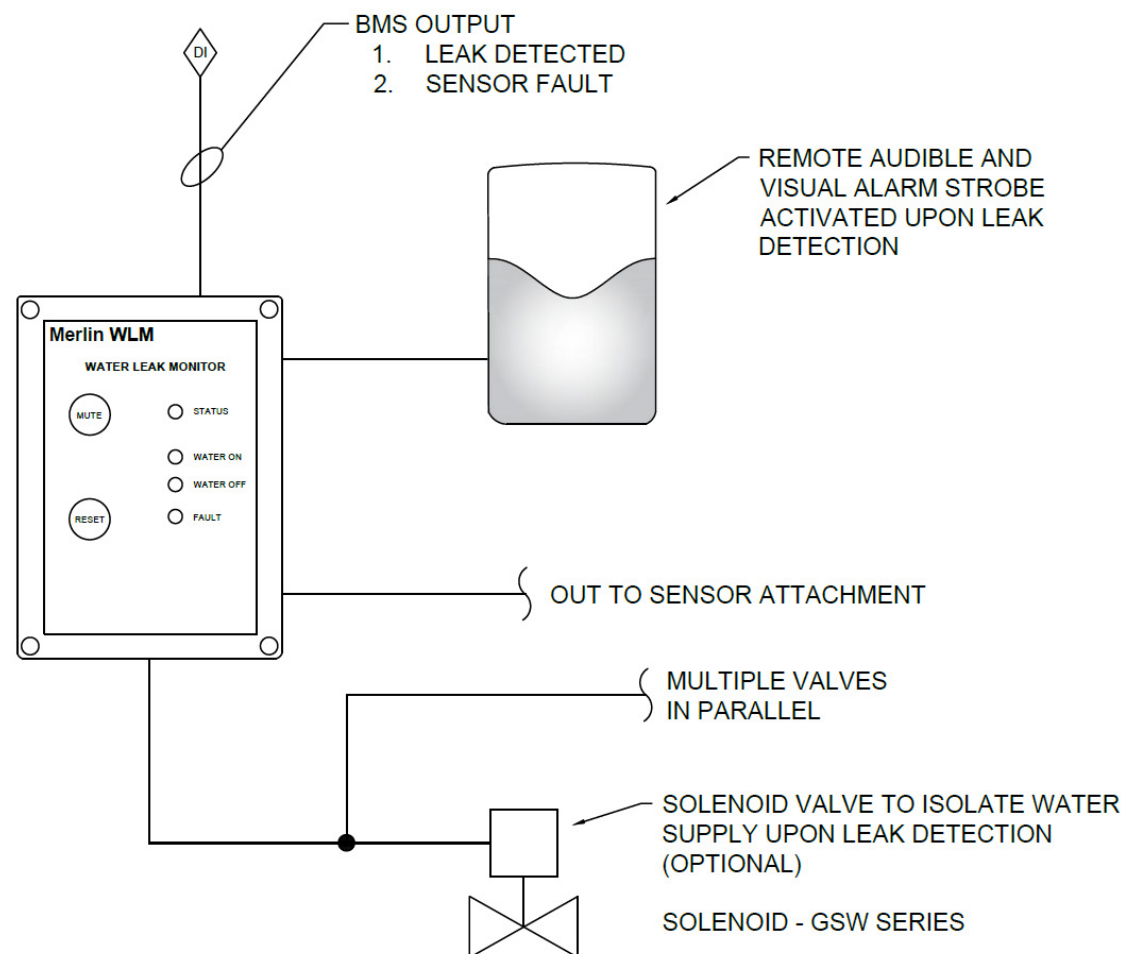

PROVIDING SAFETY & CONTROLS IN

- SCIENCE LABORATORIES
- BOILER ROOMS
- GAS & WATER FEATURES
- COMMERCIAL KITCHENS
- CAR PARKS
- OCCUPIABLE SPACES

FIND OUT MORE

info@snsnorthern.com
01257 470983